

Furniture manufacturer

Installation method

These are the installation methods for your furniture unit and how to proceed regarding door adjustments.

Notice: Don't touch the hinge adjustment screws.

- 1) Place the furniture at the appropriate place.
- 2) Check if the retractable doors are upright.
- 3) If the doors aren't upright, you'll need to place a shim, a breakaway levelling wedge (found in the furniture unit), which you will place under front or back legs, left or right.

Shim method

Lift up one of the furniture corners, front or back, and check if the alignment is right, and insert shim under this leg. If the result is not satisfactory, move one shim to one of the other legs.

FURNITURE WITH UNALIGNED DOORS

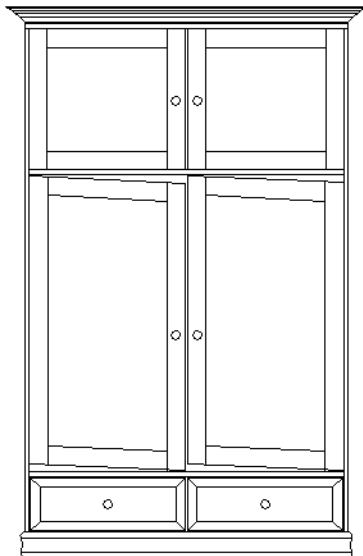

FURNITURE WITH ALIGNED DOORS

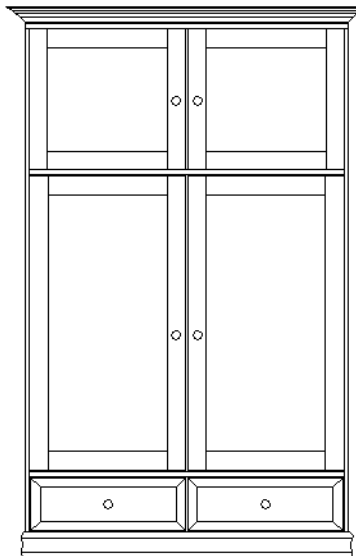

SHIM

N.B. If you move the furniture to another place, you will need to repeat the alignment installation method.

Possible problems

- a) Your retractable door is hard to push: you can spray white grease inside the track, which will lubricate the ball bearings.
- b) Your T.V. doors don't close properly on the hinge sides? You will need to open the door, push it back and pull it hard towards yourself 2 or 3 times.
- c) If your door doesn't close correctly (hard to close) on the handle side: Check if your installation method is right. If not, with a Robert's screwdriver, you can adjust again the pressure roller to make your door easier to close.

Congratulations for buying Concept Adateck Inc. Furniture
Thank you for your confidence.